

# CLUTCH CABLE CONVERSION, LATE PEDAL BOX

## PEDAL BOX CONVERSION

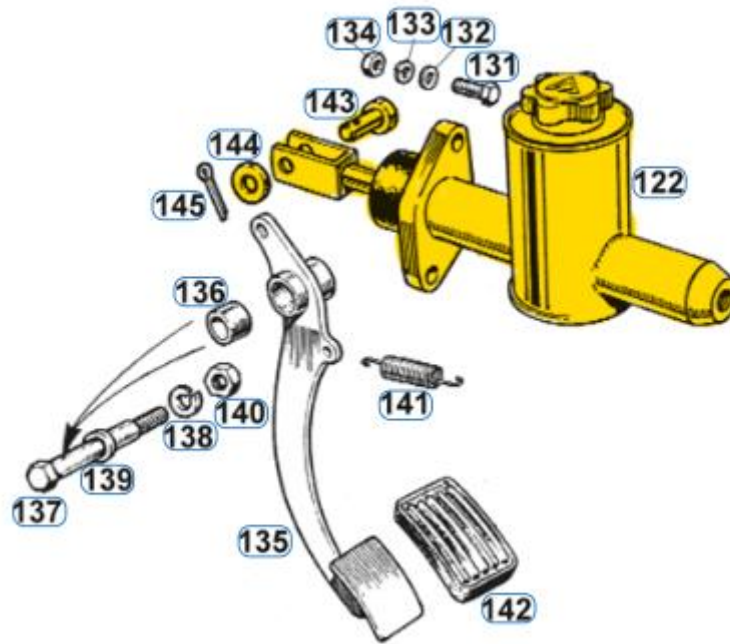

FIGURE 1: PEDAL BOX ASSEMBLY

Remove the clutch pushrod, clevis pin and clutch master cylinder, see Figure 1: Pedal Box Assembly

Drain the master cylinder before removal. Take care to not spill clutch fluid onto the paintwork. The obsolete hydraulic pipework can be capped or removed.



*FIGURE 2: CONVERTED PEDAL BOX*

Install the clutch cable adaptor cage and attach the pushrod to the clutch pedal. The length of the pushrod should be adjusted such that the pedal sits slightly higher than the brake pedal. 25mm of travel is required at the pushrod to fully disengage the clutch.

## CABLE INSTALLATION AND ADJUSTMENT

Wind the lock nuts on the clutch cable fully in to give maximum slack.

Working under the car, feed the threaded end of the cable through the hole in the engine adaptor plate and hook the cable nipple into the slot in the clutch release arm. Ensure the nipple is properly seated in the fork. See Figure 3: Fitted Gearbox

Route the cable through the engine bay avoiding any hazards such as the steering column, throttle controls or wiring and feed through the guide on the Clutch Cable Cage.

Locate the ringed end of the cable onto the spigot pin and secure using the R-Clip.

Working under the car, the threaded cable sheath should be pulled through the engine adaptor plate, towards the front the car, to eliminate any slack. With the cable tensioned with no slack the locking nuts should be locked against the adaptor plate. Ensure the nuts are tight to avoid the risk of them coming free during operation.

The cable should have no free play but should also not be applying undue load which would cause riding of the clutch.

Test drive and adjust as necessary.

After the first 1000 miles driving the cable adjustment should be checked as the cable can stretch slightly as it beds in, making gear change more difficult.



*FIGURE 3: FITTED GEARBOX*

## REPLACEMENT CABLES

The kit uses a standard Ford Escort Mk2 clutch cable, p/n 6055426.

Replacement / spare cables can be purchased from Barratt Engineering or most good motor factors.